



# Fletcher Miller School:

A Thriving Vision for the Future

March 1, 2023

Update to the Board of Education



# Today's Purpose

Update the Board on the design requirements that would best serve the needs of our students at Fletcher Miller.

# Attendees

**Matt Palaoro**

Chief Student Success Officer

**Julie Osborne**

Principal, Fletcher Miller School

**David Suppes**

Interim Chief Operations Officer

**Terry Walderman**

Executive Director of Student Services

**Mayraj Syed Peer**

Project Manager, DLR Group

**Greg Cromer**

Managing Principal, DLR Group

**DAG Committee**

Krista Taylor, Paraeducator

**Berry Jones**

Director of Construction Management

**Tim Reed**

Executive Director of Facilities

**Danelle Berzoza**

Construction Project Manager

**Margaret Huffman**

Director of Health Services

**Liza Meier**

Executive Director of Special Education

**DAG Committee**

Kacie Nievesmassol, Parent



# Special Thanks

## **DLR Group**

Greg Cromer, Mayraj Syed Peer, AJ Sivakumar, Sarah Gilloran, & Amanda Colleen

## **Julie Osborne**

Principal, Fletcher Miller School

## **Terry Walderman**

Executive Director of Student Services

## **Marie Lucero**

Facility Manager

## **Lyn Porter**

Paraeducator

## **Dave Westdal**

PE Teacher

## **Julie Palmer**

Physical Therapist

## **Kristen Stensland-Fandrick**

Paraeducator

## **Krista Taylor**

Paraeducator

## **Robin Leonard**

Special Education Teacher (K-12)

## **Dallas Stankman**

Jeffco Transition Services (18-21)

## **Kristin Steadman**

Parent

## **Kacie Nievessmassol**

Parent



# Fletcher Miller School



## **School Mission:**

All students with unique needs deserve access to a high quality education that promotes independence and autonomy for a lifetime of learning.

# Our Learners. Our Future.

**Who we serve:** Preschool - age 21

**Current Enrollment:** 98 students

## Programs include:

- **Integrated Preschool**
  - Traditional early childhood program
- **Separate Preschool**
  - Students attending a separate special education class
- **K-12 program**
- **Jeffco Transition Services (18 - 21)**
  - Preparing young adults for life after school
- **Lighthouse Program**
  - Students with greater adaptive behavior needs



## Instructional Focus

- Communication and Literacy
- Environmental Access
- Advocacy and Independence
- Functional Academics
- Leisure Activities

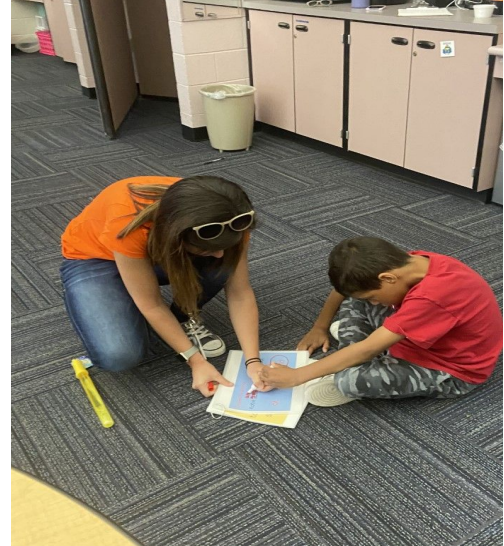

## Current Staff includes:

- **16** Teachers
- **2** Registered Nurses
- **3** Physical Therapists
- **4** Occupational Therapists
- **4** Speech Language Pathologists
- **34** Paraeducators
- **4** Contracted Positions
- **2** Instructional Coaches
- **2** School Administrators
- **3** Office Support Staff
- **3** Facilities Staff





## Fletcher Miller's Current Values, Beliefs and Actions

- 2:1 or 3:2 Student to Staff Ratio
- Authentic & Engaging Instruction
- Experiential Learning
- Teaming: Co-Teaching, Co-Treating
- Instruction Occurring in Classrooms Rather than in Isolation
- Intensive Therapy to Address Foundational Needs
- Every Kid, Every Day

# Our Learners. Our Future.



## Fletcher Miller: Unique Student Facility Needs

- Wide hallways, doorways and bathrooms
- Bigger classrooms
- Efficient Equipment Storage that is accessible to classrooms
- Reliable HVAC
- Easy access to medical services
- Hallways with 90 degree angles – this will aid student navigation and independence
- Multiple accessible bathrooms and hygiene areas
- Central location that is not adjacent to a major street

## One Success Story



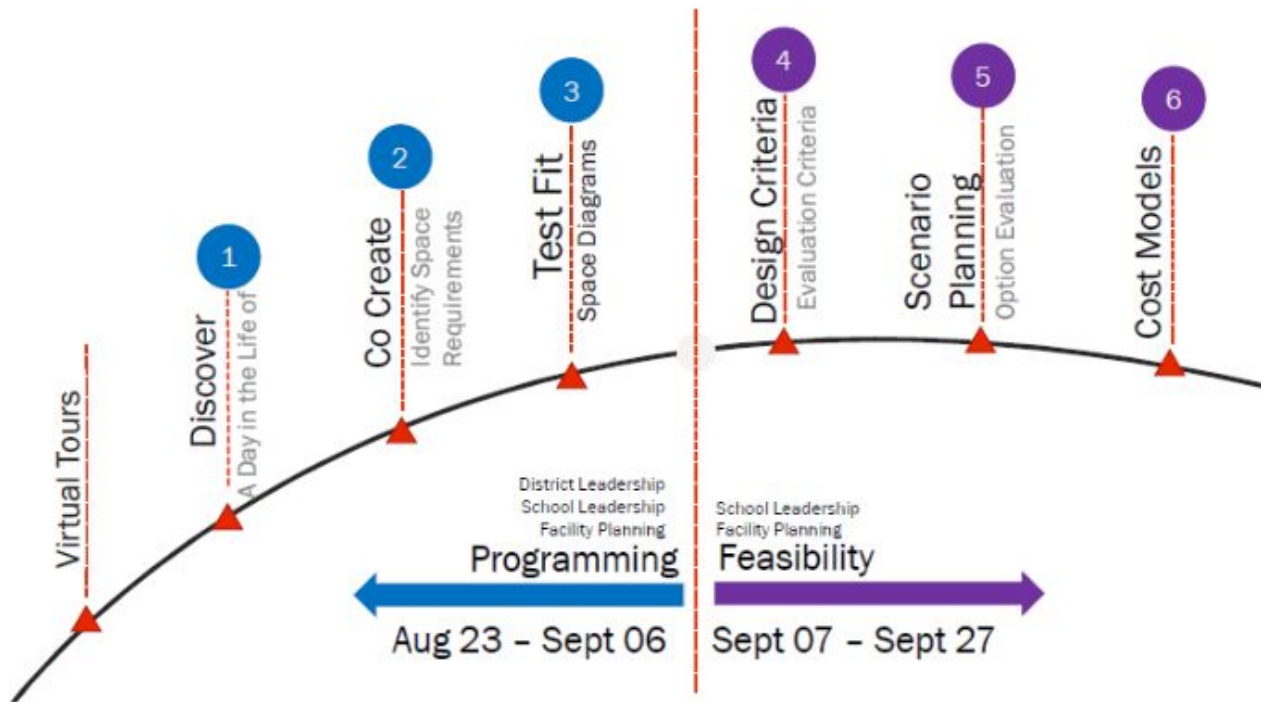

- Maximize learning time by decreasing time spent on personal care and travel between spaces
- Create a fun and welcoming environment that reflects Fletcher Miller's culture as a family and community
- Develop spaces that integrates family and community involvement

- Provide a variety of spaces that support a greater diversity of learning activities and modalities
- Create an environment that supports educators and care providers in meeting the diversity of student needs
- Take into consideration the future shifts in operations, care directives, and support technology to ensure that the future Fletcher Miller can successfully support students both now and in the future

## Program Summary

Admin. Area  
Pre-k Learning  
K-12 Learning  
Lighthouse Learning  
Jeffco Transition Learning  
Vocational Learning  
Library/Media  
Food Service  
Art | Music | P.E.  
Health Clinic  
Therapy Space  
Building Support

### CRITICAL PROGRAM ADJACENCIES

- **K-12 Learning Community Single Cohort**
- **Loop Within the Building**
- **Pre-K | JTS | Lighthouse - Own Cohorts**
- **Clinic Needs To Be Centrally Located**
- **Lighthouse Needs to be Separated from Pre-K and K-12**
- **ADL and JTS Can Be Combined**
- **Music or Commons Can Serve As Stage**



## CRITICAL PROGRAM ADJACENCIES

- **K-12 Learning Community Single Cohort**
- **Loop Within the Building**
- **Pre-K | JTS | Lighthouse - Own Cohorts**
- **Clinic Needs To Be Centrally Located**
- **Lighthouse Needs to be Separated from Pre-K and K-12**
- **ADL and JTS Can Be Combined**
- **Music or Commons Can Serve As Stage**

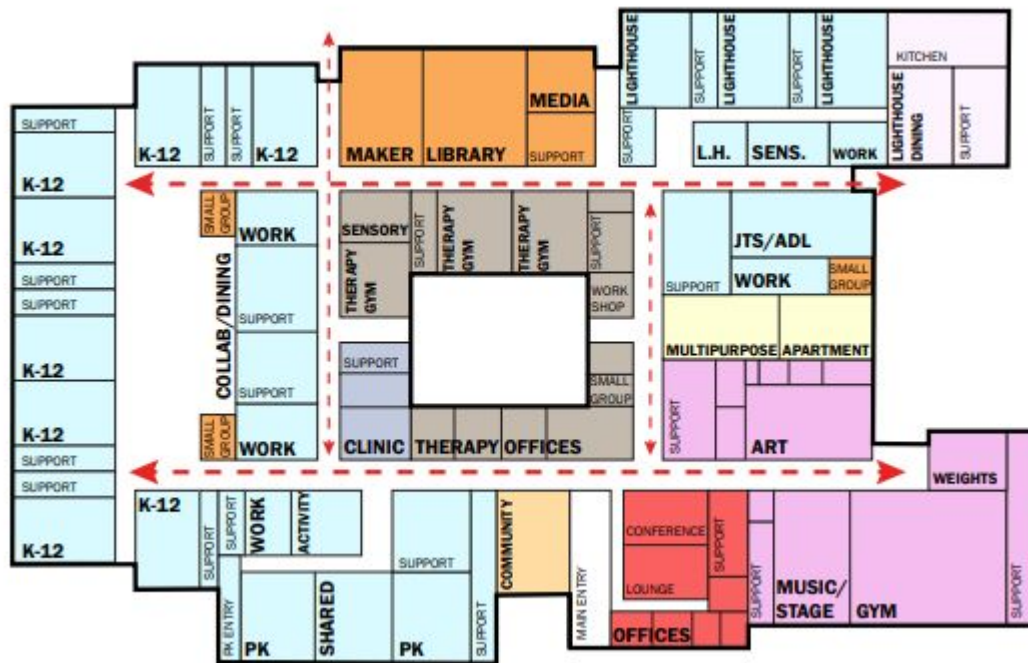

The intent of this diagram is not to be an exact floor plan, but to demonstrate the ideal adjacencies between program elements. This diagram has been used to evaluate the different options in the scenario planning portion of this study.

### **Scenario 1: New Build**

Construct a new school facility at the current site (adjacent to current school).

### **Scenario 2: Renovation and Expansion of Existing Facility**

Renovate and add on to the current Fletcher Miller School facility.

### **Scenario 3: Renovation of Another District Facility**

Relocate the Fletcher Miller School to another location and renovate an existing facility. (Preferred Vicinity Range: West 44th to Florida Ave.)

**Current Property:** Approximately 55,000 square feet

**Optimal Design:** Approximately 66,000 square feet

## Preliminary Construction Estimates

<b>Renovation of Another District Facility</b>	<b>Renovation &amp; Expansion of Existing Facility</b>	<b>New Build</b>
\$19M - \$25M	\$23M - \$27M	\$28M - \$32M

## Getting to the Right Answer

- Student impact
- Desired program adjacencies, educational requirements, and project goals
- Summary of estimated costs and best long-term investment
- Location
- Construction impacts
- Future flexibility
- Define a workable schedule (23 - 24 SY, 24 - 25 SY) including transition support requirements
- Board recommendation (June 2023) & securing funding

# Our Learners. Our Future.





# Thank You

Comments? Questions?